



**CUSHMAN &  
WAKEFIELD**

**FOR LEASE  
EASTLAKE CAMPUS  
8339 EASTLAKE DRIVE  
BURNABY, BC**

**Unprecedented Campus Style Development / Office & Flex-Industrial Opportunities**

**PHASE III - BUILDING 3B**

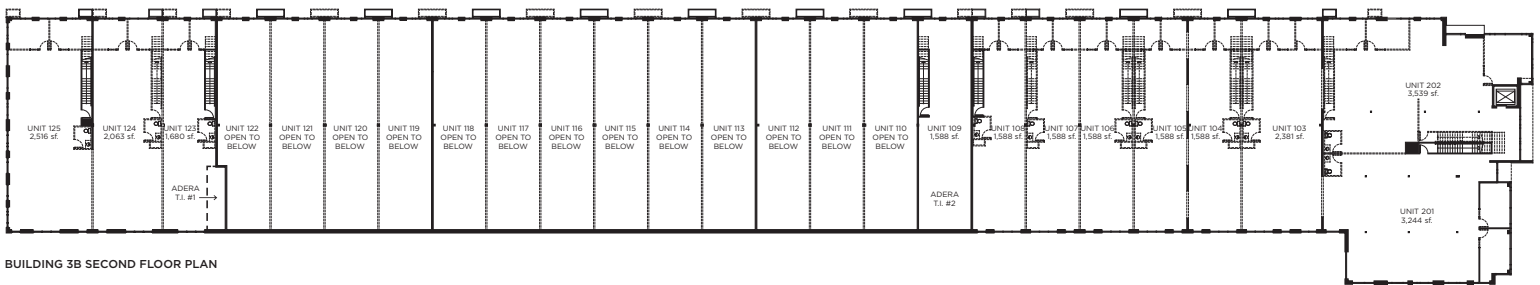

**BUILDING 3B SECOND FLOOR PLAN**

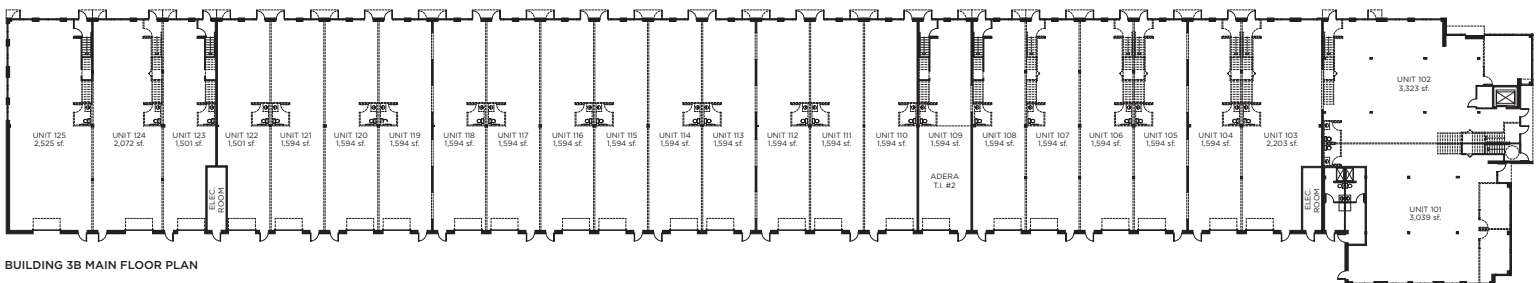

**BUILDING 3B MAIN FLOOR PLAN**

*Floor plans are approximate and subject to change.*

**Roger Leggatt**  
Personal Real Estate Corporation  
Vice President, Office Leasing  
604 640 5882  
roger.leggatt@ca.cushwake.com

**Max Zessel**  
Personal Real Estate Corporation  
Associate Vice President  
604 640 5824  
max.zessel@ca.cushwake.com

**Liam Boulton**  
Associate  
Leasing & Sales  
604 629 5023  
liam.boulton@ca.cushwake.com



Suite 700 - 700 West Georgia Street / PO Box 10023, Pacific Centre / Vancouver, BC V7Y 1A1 / 604 683 3111 / 1 877 788 3111 / [cushmanwakefield.com](http://cushmanwakefield.com)

E.&O.E.: This communication is not intended to cause or induce breach of an existing agency agreement.

The information contained herein was obtained from sources which we deem reliable and, while thought to be correct, is not guaranteed by Cushman & Wakefield Ltd. 07/17 bg